

Audo

COPENHAGEN



ANDROGYNE SIDE TABLE
Designed by *Danielle Siggerud*



ANDROGYNE SIDE TABLE, Ø40
Designed by *Danielle Siggerud*

Perfectly proportioned, the Androgyne Side Table balances a rounded marble tabletop on a powder coated steel base that features wide, flat legs, laser-cut for precision. The architect-designed piece is offered in a number of materials that can be co-ordinated or contrasted as desired. The latest addition to the collection is a tabletop in Emperador marble, a richly veined marble with intense brown tones, as well as calcatta viola, already known from the Plinth Collection. Carefully selected for its inherent beauty and light-reflecting qualities, the different marble tops provide a top provides a tactile and natural contrast to the sleek metal.



PRODUCT OPTIONS

Tabletop



CRYSTAL ROSE MARBLE

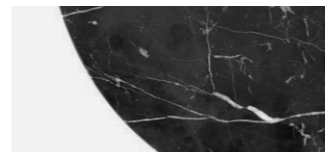

NERO MARQUINA MARBLE

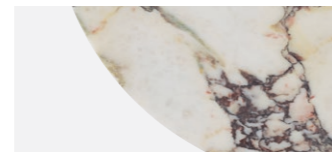

CALACATTA VIOLA MARBLE

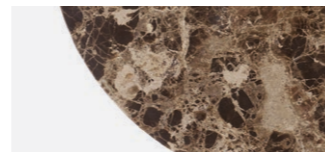

EMPERADOR MARBLE

Powder coated steel base



IVORY STEEL

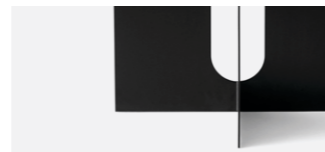

BLACK STEEL

PRODUCT TYPE
Side table

COLLI
1

Environment
Indoor

DIMENSIONS

Steel base
H: 43 cm / 16,9"
Ø: 40 cm / 15,7"

Steel base with marble top
H: 44,8 cm / 17,6"
Ø: 42 cm / 16,5"

PRODUCTION PROCESS
Welded CNC-cut steel sheet with powder coated finish. The table top are CNC milled and treated with a sealer.

TECHNICAL SPECIFICATIONS

COLOUR

Marble top
Crystal Rose
Nero Marquina
Calacatta Viola
Emperador

Base
Black (RAL 9005)
Ivory (NCS S 1002-Y50R)

MATERIALS

Powder coated steel and Crystal Rose marble, Nero Marquina marble, Calacatta viola marble or Emperador marble.

GLOSS
Gloss 5-10

WEIGHT

Marble top: 6,9 kg / 15,2 lb
Steel base: 9,7 kg / 21,4 lb

TEST
N / A

CERTIFICATIONS
N / A

PACKAGING TYPE
Gift box

PACKAGING MEASUREMENTS
(H × W × D)

Marble top
16 cm × 49,5 cm × 49,5 cm /
6,3" × 19,5" × 19,5"

Steel base
49 cm × 43 cm × 43 cm /
19,3" × 16,9" × 16,9"

MATERIALS & MAINTENANCE
Please visit audocph.com for materials, care and maintenance instructions.

STEEL BASE

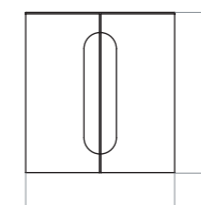
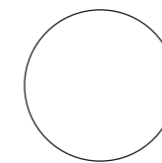

Ø: 40 cm / 15,75"

STEEL BASE WITH MARBLE TABLETOP

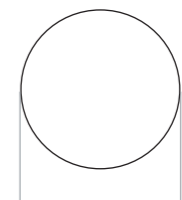

Ø: 42 cm / 16,5"

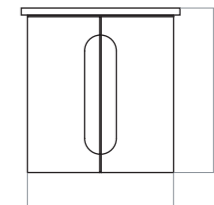

Ø: 40 cm / 15,75"

A beautiful and practical furniture design that makes clever use of craftsmanship and tactile materials, the simple silhouette of the Androgyne Side Table is characterised by opposites. The pure use of materials contrasts with a refined silhouette of solid and soft lines, living up to its name thanks to its combination of masculine and feminine characteristics. The pairing of rich oak – with a natural or dark stained finish – walnut and Kunis breccia stone creates a distinctive design customisable to any and every interior style.



PRODUCT OPTIONS

Tabletop



NATURAL OAK

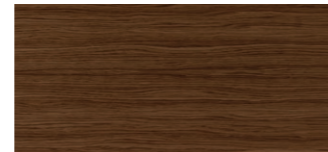

DARK STAINED OAK

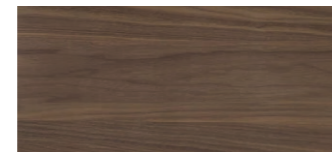

WALNUT

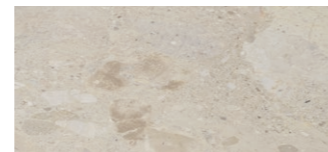

KUNIS BRECCIA STONE

Base

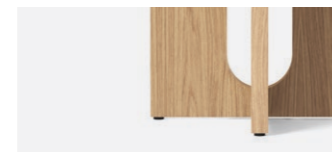

NATURAL OAK

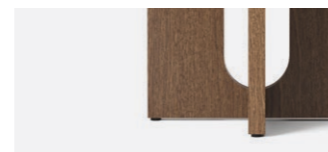

BLACK STEEL

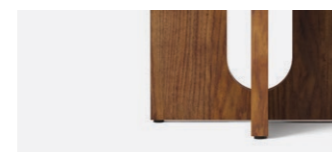

WALNUT

PRODUCT TYPE
Side table

COLLI
1

Environment
Indoor

DIMENSIONS
H: 39 cm / 15,4"
Ø: 50 cm / 19,7"

PRODUCTION PROCESS
CNC-cut and hand-polished stone or CNC-cut MDF with oak or walnut veneer. CNC-cut steel fitting with powder coated finish.

Being composed of a natural material, each product is unique and the surface may nuance compared to the images.

COLOUR

Tabletop
Natural oak
Dark stained oak
Walnut
Sand (Kunis breccia stone)

Base
Natural oak
Dark stained oak
Walnut

TECHNICAL SPECIFICATIONS

MATERIALS
Kunis breccia stone, MDF, oak or walnut veneer, powder coated steel, PA plastic glides

WEIGHT
Wood tabletop: 4,8 kg / 10,6 lb
Kunis Breccia tabletop: 8,9 kg / 19,6 lb
Wood base: 6,6 kg / 14,6 lb

TEST
N / A

CERTIFICATIONS
TSCA title IV compliant

PACKAGING TYPE

Wood tabletop
Brown box

Kunis Breccia tabletop
Wood crate

Base
Brown box

PACKAGING MEASUREMENTS
(H × W × D)

Wood tabletop
6 cm × 55 cm × 55 cm /
2,4" × 21,7" × 21,7"

Kunis Breccia tabletop
4,5 cm × 58 cm × 58 cm /
1,8" × 22,8" × 22,8"

Base
19 cm × 26 cm × 41 cm /
7,5" × 10,2" × 16,1"

MATERIALS & MAINTENANCE
Please visit audocph.com for materials, care and maintenance instructions.

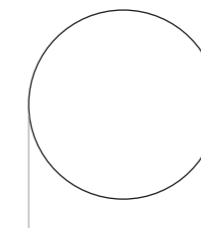

Ø: 50 cm / 19,7"

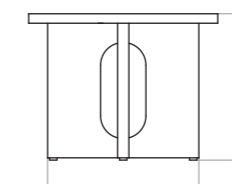

H: 39,5 / 15,5"

W: 35,5 cm / 14"